

Elderly & Disabled Housing, Page 3

NORTHEAST NEWS

Serving the Neighborhoods of Aldine, Greenspoint, US59 Eastex, Beltway 8 and North Forest for over 42 Years
VOL. 43, NO. 05 TUESDAY, JANUARY 29, 2019 HOUSTON, TEXAS www.nenewsroom.com

Cantu Thank You...



RICHARD CANTU was recently elected to the Harris County School Board. See his Thank You celebration on Page 8.

INSIDE THIS ISSUE:
School News.....2
Community News.....3
Opinion.....4
Entertainment.....5
Lifestyle.....6
Church Page.....7
Community Support.....8

NEWS NOTES

Green Forest CC Meeting

Green Forest Civic Club will have its st meeting of 2019 on Tuesday, January 29, 2019 at 6:30 p.m. at the American Legion Hall located at 3415 Aldine-Mail Rte. They will be celebrating the New Year with light snacks. Feel free to bring something to share. All of Green Forest Civic Club meetings are open to the public. For more information, feel free to contact Shirley Reed (President) at 281-449-7531, or Marina Sugg (Secretary) at 281-684-9751.

Aldine ISD FFA Show

The 60th annual Aldine ISD Livestock Show and Country Fair will be held Jan. 30-Feb. 1 at the M.O. Campbell Educational Center, 1865 Aldine Bender Rd, Houston, TX 77032. Project judging will be held on Thursday, Jan. 31, beginning at 8 a.m. and concluding at 4 p.m. in the Campbell Center Arena. On Thursday and Friday, all projects will be on display to the public throughout the day. The Sale of Champions, which produced \$224,007 in sales in 2018, will be held Friday evening (Feb. 1) at 7 p.m. and will be held in the Arena.

Pct.2 distributes food during government shutdown

HARRIS COUNTY PCT. 2 – During the current federal government shutdown, veterans and federal employees impacted were able to get food baskets and resource guides at two Food Fairs held at Precinct 2 community centers. Pct. 2 Commissioner Adrian Garcia partnered with the Food Bank to provide drive-thru style support at the Northeast Community Center, and East Harris County Activity Center. Garcia said the event will repeat in the future if necessary.



Commissioner Garcia helps load food into an employee's car.



Precinct 2 staff turned out last Friday morning to help distribute the food.

SUPERBOWL PREVIEW

Patriots look to tie Steelers with 6th Lombardi: Rams look to make McVay youngest head coach to win SB

There will be a lot at stake on Sunday in Super Bowl LIII when the New England Patriots take on the Los Angeles Rams in Atlanta's Mercedes Benz Stadium. A win by Bill Belichick's Patriots would give them six Lombardi Trophies and tie them with the Pittsburgh Steelers who earned their sixth SB title in 2009 with a win in Arlington over the Green Bay Packers. A NE victory would make Belichick and his quarterback, Tom Brady, the only head coach/QB combo to win six titles. The Steelers won four with Terry Bradshaw and two the Ben Roethlisberger. A win by the Rams would make head coach Sean McVay the youngest head coach in NFL history to win the Lombardi Trophy. McVay turned 33 last Thursday and the young wonder kid has led the re-



surgent Rams to 26 victories in his first two years as their head coach. Ironically, the Rams are returning to the site of their lone Super Bowl victory, which came after the 1999 season in the old Georgia Dome when they defeated Tennessee 23-16. You will have to excuse New Orleans Saints fans if they decide not to watch SB LIII after a badly missed non-call could have cost them a trip to Atlanta. I'm sure most of you are aware of the play I'm referring to. With time running

down in the NFC Championship game, quarterback Drew Brees lofted a pass down the right sideline to wide receiver TommyLee Lewis. Rams defensive back Nickel Robey-Coleman launched himself into Lewis before the ball arrived, but no interference, or helmet-to-helmet contact, was called. Saints head coach Sean Payton and their fans were livid, which they should have

See Patriots Vs Rams, Page 3

East Aldine bond rating upgraded by S&P

EAST ALDINE – David Hawes, executive director of the East Aldine District, reports that Standard & Poors, the nationwide credit rating service, has upgraded its evaluation of the District. The result of this upgrade is that bonds that the District sells will have a lower interest rate, leaving a larger net cash reserve for use in the ongoing community projects that the District is undertaking. The East Aldine Management District has been given a rating of AA- according to S&P Global Ratings. This is primarily due to: continued expansion and diversification of the district area; a very strong audited sales tax collections through 2017 and debt service coverage (DSC) at 3.5x MADS. The raters view that nationwide sales tax revenue collections have exhibited relatively low volatility with no history of significant volatility at the local level; and

the district's general creditworthiness partially offsets the above credit strengths of the sales tax bond structure. Some excerpts from the final S&P rating report follow: S&P Global Ratings raised its long-term rating and underlying rating on East Aldine Management District, Texas' series 2009 and 2016 tax-increment contract revenue bonds to 'AA-' from 'A' due to its criteria application of the "Priority-Lien Tax Revenue Debt," published Oct. 23, 2018. The outlook is stable. The bonds are a special obligation of the district, payable from, and secured by, a lien on and pledge of gross proceeds of a 1% sales-and-use tax levied within the district, plus an additional 1% special zone sales tax covering a portion of the

See Bond Rating, Page 8

Comm. Adrian Garcia visits Castlewood CC

Commissioner Adrian Garcia's visit to Castlewood at Bethel Community Church last Thursday proved productive and informative. The Commissioner listened attentively to the concerns of its residents such as bayou and ditch cleanup, water drainage from ditches, security issues, excessive gunfire in the area, maintenance of vacant lots and abandoned cars, dumping, problems

with septic tanks and its possible conversion and heavy trash pickup. Commissioner Garcia set priorities for the subdivision, first and foremost he said, is the flood mitigation beginning with identifying the proper sheet flow, stripping of the streets in the area, street repair of pot holes and ap-

See Castlewood CC, page 6



Commissioner Adrian Garcia, left, with Castlewood Civic Club members including President Connie Esparza at last week's meeting.

MARKETPLACE - Please Mention the NORTHEAST NEWS when you visit our Advertisers.

Pan Riko BAKERY
Cittally
5216 Aldine Mail Rte. 281-442-1991
Wednesday 4 Bolillos for \$1

EAST ALDINE DISTRICT
www.aldinedistrict.org
911-Emergencies 713-221-6000 Dispatch
Aldine Storefront 281-449-6600
Capt. Ken Melancon District II

PREMIERE CINEMAS
FRIDAY-WEDNESDAY 1/25-1/30

* The Kid Who Would Be King (PG) - 12:30pm, 3:15pm, 6:00pm, 9:10pm Stadium Seating	* AQUAMAN 3D (PG-13) - 12:00pm, 6:15pm SPA-Spanish Dubbed; Stadium Seating
* SERENITY (R) - 1:00pm, 3:30pm, 6:30pm, 9:20pm Stadium Seating	* BUMBLEBEE (PG-13) - 3:10pm, 8:30pm SPA-Spanish Dubbed; Stadium Seating
* GLASS (PG-13) - 12:00pm, 3:00pm, 6:00pm, 9:00pm Stadium Seating	* BUMBLEBEE (PG-13) - 3:35pm, 9:15pm Stadium Seating
* GLASS (PG-13) - 12:00pm, 2:50pm, 5:45pm, 8:45pm SPA-Spanish Subtitles; Stadium Seating	* BUMBLEBEE in 3D (PG-13) - 1:00pm, 6:30pm Stadium Seating
* DOG'S WAY HOME (PG) - 12:00pm, 4:45pm, 9:30pm Stadium Seating	* BUMBLEBEE in 3D (PG-13) - 12:30pm, 5:45pm SPA-Spanish Dubbed; Stadium Seating
* THE UPSIDE (PG-13) - 12:00pm, 2:45pm, 5:45pm, 8:45pm Stadium Seating	* SECOND ACT (PG-13) - 1:00pm, 4:00pm, 6:30pm, 9:20pm Stadium Seating
* ESCAPE ROOM (PG-13) - 2:15pm, 7:00pm Stadium Seating	* THE MULE (R) - 12:20pm, 3:25pm, 6:25pm, 9:10pm Stadium Seating
* AQUAMAN (PG-13) - 3:10pm SPA-Spanish Dubbed; Stadium Seating	* SPIDER-MAN: Into the Spider-Verse (PG) - 12:40pm, 3:15pm, 6:15pm, 9:00pm Stadium Seating
* AQUAMAN (PG-13) - 4:00pm Stadium Seating	* CREED II (PG-13) - 7:45pm Stadium Seating
* AQUAMAN 3D (PG-13) - 12:30pm, 7:30pm Stadium Seating	* RALPH BREAKS THE INTERNET (PG) - 12:00pm, 2:35pm, 5:15pm Stadium Seating

*No passes on these movies ** No passes accepted for 3D movies. ID Required for R rated movies.
New Releases, no passes accepted for the first two weeks *Sorry No Passes **CLOSED CAPTION
***Policy prohibits admission of ANY child 6 or under to any R-rated movie after 8pm. NO EXCEPTIONS.

PRICES: Early Bird Special - First Show Mon-Fri: \$4.75
Children & Seniors \$5.50 • Matinee \$5.50 all shows before 6 pm
General Admission \$7.50 • 3D additional \$2
Major Credit Cards Accepted BOX OFFICE OPENS AT 11:30 A.M.

GREENSPPOINT MALL 12300 North Freeway #400 Houston, TX 77060
Movie Hotline: 281-873-8888 • Theater 281-874-1141 • www.pccmovies.com

Furrytails Dog Grooming
407 NOONDAY LANE, HOUSTON TX 77060
281-445-9780
www.furrytdg.com
Mon - Fri 7:30 am - 6:00 pm
Sat 7:30 am - 5:00 pm
Your neighborhood groomer at an affordable price!
Services Available: • Flea & Tick Dips • Full Bath & Blow Dry • Nail Trims • Hair Style per Your Instructions • Teeth Brushing • Dog Accessories •

CONFESSIONS:
TUESDAY, WEDNESDAY AND THURSDAY FROM 6 TO 6:50 PM,
SATURDAYS FROM 4 TO 4:50 PM,
FROM 6:30 PM TO 6:50 PM
ST CHARLES BORROMEO CHURCH
501 TIDWELL RD, HOUSTON, TX
BETWEEN I-45N & HARDY TOLL RD
713-692-6303

COMMUNITY & SCHOOL NEWS

Aldine District-Level Winners of 2019 HLSR School Art Competition Announced

A total of 45 students represented AISD at the NRG; eight will advance to the next level of the contest.

Aldine ISD held the Houston Livestock Show and Rodeo (HLSR) School Art Reception on Jan. 17 at the M.O. Campbell Educational Center. After two rounds of judging by the Show's School Art Committee, Dr. Michaelann Kelley, AISD director of visual arts, announced the winners at the reception.

Schools participating in the HLSR School Art Contest annually host district-level competitions.

Each year, judges select winners in elementary, junior high and high school levels. The entries receive a red, white or blue ribbon. Finalists for the top awards receive a teal ribbon. It is from the teal ribbon group that judges select the Best of Show, Gold Medal, and Special Merit awards.

In addition to their award, Best of Show and Gold medal winners also received tickets to the rodeo to see their artwork at the Hayloft Gallery. Some students will also receive invitations to the Glassel School of Art and Western Art Academy.

All eligible artwork from school in the Houston area will be auctioned. In 2018, the Grand Champion work of art sold for \$225,000, while the Reserve Grand Champion fetched \$150,000. Based upon placing, the Houston Livestock Show and Rodeo™ establishes a guaranteed minimum payment for each exhibitor who qualifies for the junior auctions. The Rodeo also sets a cap amount above the guaranteed minimum for each auction lot. When bidding exceeds the cap amount, the additional funds go into the Rodeo's Educational Fund to be used for scholarship and grant recipients. Amounts bid between the guaranteed minimum and the cap are accumulated in the bonus pool and are used to cover any lots that did not bring the guaranteed amount.

The HLSR kicks off Feb. 25 at the NRG and ends Mar. 17. A total of eight AISD winners in the high school, middle school, and elementary school divisions will be displayed in the Hayloft Gallery at the NRG Center during the HLSR.

The selections have already been taken to NRG Arena for the next level of the contest.

More than 500 people attended the AISD Reception, which had more than 600 student artworks on exhibit. The works represented 48 schools across the District.

Before the reception ended, Dr. Michaelann

Kelley, director of visual arts, thanked everyone for supporting arts education.

"Arts learning experiences play a vital role in developing students' capacities for critical thinking, creativity, imagination and innovation. These capacities are recognized as core skills and competencies all students," said Kelley. "The arts not only encourages personal expression and artistic voice but educational research also shows a correlation between exposure to arts education and scoring higher on standardized tests and college entrance exams such as the SAT and ACT.

"Thank you to the students for gracing us with their talent, and to our supportive parents who come out time and time again to cheer their kids on. Thank you district- and campus-level administrators that help make the visual arts program happen. And last, but not least, my sincerest gratitude to the Aldine visual arts teachers that work tirelessly for our students. "Every single one of you represents our District motto: All in. All Students. Always!"

HLSR District Contest Winners

High School Division
Best of Show
"Curious Bell" by Emely Majano of MacArthur High School

Gold Medals
"A Gentle Kiss" by Paola Gomez of Nimitz High School
"Chick Gaze" by Tram Nguyen of Eisenhower High School

Special Merit
"Watching You" by Janeth Santos, Blanson Career and Technical High School

Middle School Division
Best of Show
"Cactus Night" by Joshua Zaragosa, Houston Academy

Gold Medal
"Early Learners" by Juniper Boehler, Jones Middle School

Elementary School Division
Best of Show
"Spiky Cactus" by Genesis Ruiz, Kujawa EC/Pre-K/K School

Gold Medal
"The Horse With Shapes" by Emily Velazquez, Anderson Academy

Elementary School Finalists
"La Ranchera" by Lilianna Benjume of Carter Academy
"The Midnight Glow" by Ana Garza of Kujawa Elementary School
"Oops!" by Conrado Guerra of Kujawa Element-

tary School
"Ghost Stallion" by Tommy Hernandez of Kujawa Elementary School

"Moo Selfie" by Evelin Rodriguez of Kujawa Elementary School

"El Pollo Loco" by Valeria Vasquez of Kujawa Elementary School

"Say, What?" by Nalea Woods of Kujawa Elementary School

"In the Meadow" by Erick Munguia of Worsham Elementary School

"The Desert" by Lauren Butler of Drew Academy

"Texas Cow Skull" by Alessandra Garcia of Drew Academy
"Pastel Bones" by Nija Whittington of Drew Academy

"Rooster" by Mariana Vasquez of Grantham Academy

"Warrior" by Maximilian Cortes of Hoffman Middle School

"Walking Through the Ranch" by Charley Basalto of Plummer Middle School

"Lonely" by John Duong of Shotwell Middle School
"Botas" by Damaris Garcia of Stovall Middle School

High School Finalists

"The Runaway Train" by Isabel Castill of Aldine High School

"The Rose" by Elyan Jacob of Blanson Technical High School

"Three Wranglers" by Angel Chavez of Blanson Technical High School

"A Long Way Home" by Abigail Gonzalez of Carver High School

"El Toro" by Vanessa Arias of Carver High School

"The Golden Goat" by Daphne Lopez of Carver High School

"Prismatic" by Barbara Villarreal of Carver High School

"M" by Amy Lopez of Davis High School

"El Trabajo del Pastor" by Itzel Gomez of Eisenhower High School

"Remembering Home" by Shonease Murphy of MacArthur Ninth Grade School

"The Cow" by Angel Franco Ramirez of MacArthur Ninth Grade School

"Wild Mare in a Vast Desert" by Emily Estrada of MacArthur High School

"Howdy" by Alexis Martinez of MacArthur High School

"La Vaca" by Dulce Torres of MacArthur High School

"Wilbur" by Aristi Perea of Nimitz Ninth Grade School

"Moo Moo & Friends" by Iris Barrera of Nimitz High School

"Time" by Nicole Jimenez of Nimitz High School

"Farmyard" by Isabel Rivas of Nimitz High School

"Free-range Riding" by Giselle Rubio of Nimitz High School

"Moo" by Jared Solano of Nimitz High School

Carver HS Forensics team earns National Charter Status



Carver HS' speech and debate team members celebrate after the Dekaney tournament.

Carver High for Engineering, Applied Technology and the Arts recently received the prestigious charter member status in the National Speech and Debate Association (NSDA). This is the highest school membership honor you can achieve in the association.

The honor is based on the students' participation in, and performance at numerous debates and related activities. Students and coaches earn points in the Honor Society through speech and debate competition, community service, public speaking and leadership activities. The more points earned, the higher degrees of recognition received.

Anthony Cobb coaches the team expects to have 25 students taking part during the 2018-2019 season.

"Charter membership reflects sustained commit-

ment to excellence," said Cobb. "I am extremely proud of my students for their hard work and passion for speech and debate."

Debate is more than arguing your view. Participants must put together reasoned, well-supported arguments, and they all must represent both sides of an issue.

What students learn is applicable to real life in terms of seeking employment, academics, building personal and professional relationships. Many famous people are former debaters, including Oprah Winfrey, Sonia Montemayor, Stephen Colbert, Idina Menzel, former President Jimmy Carter and BD Wong.

Cobb isn't the only one excited about the recognition. Narius Nedd, a senior and third-year team member, is proud of the honor.

"We started from nothing," said Narius. "No one knew us on the tournament circuit. Kids at Carver didn't even know we had a speech and debate team."

"I am proud that we started from scratch and are creating what we hope is a legacy at Carver."

Rostrum recently featured the Carver team in the November issue. Rostrum is the official magazine of the National Speech and Debate Association. Each school year, the magazine provides the speech and debate community with news, scholarly articles and national updates.

Every school within the NSDA is designated a provisional chapter, member chapter, or charter chapter. Each status determines voting privileges, a district's strength of chapters, and the number of qualifiers to the annual National Speech & Debate Tournament.

Annual District Spelling Bee set for February 6

A total of 52 students will face off as they vie for a chance to head to Houston Public Media Spelling Bee.

After months of preparation and several rounds of competitions at the campuses, 52 Campus Spelling Bee Champions representing schools across the District will face off at the AISD Spelling Bee, which is set for February 6 from 4-7 p.m. at the M.O. Campbell Educational Center, located at 1865 Aldine Bender Rd. Each one is competing for a chance to advance to the Houston Public Media Spelling Bee.

Since September, AISD students at elementary and middle school campuses taking part in the Spelling Bee have been studying more than 1,150 words from 12 languages of origin. The words come from the Merriam-Webster Online Dictionary and the Scripps National Spelling Bee study site.

Margaux P. Jones, program director of elementary languages arts, states there are many good reasons for students to take part in spelling bees. According to Jones, the purpose of the program is to help students improve their spelling, increase their vocabularies, learn concepts and develop correct English usage that will help them all their lives.

Spelling is a key to understanding. Using correct



Miguel González (left) and Marina Ly are all smiles after winning the AISD 2018 Spelling Bee.

spelling and grammar ensures that people understand what you want them to understand.

Jones encourages students' classmates, parents, staff and community members to come out and support the spellers. Jones is the District Spelling Bee coordinator.

"It would be wonderful to have everyone come out and support our competitors who have worked so hard to reach the district competition," said Jones. "The students need to hear the community cheering

them on."

The District Champion and Runner-Up will advance to the Houston Public Media Spelling Bee. The regional contest is set to take place March 23, 2019. The winner of the Houston Public Media Spelling Bee will advance to take part in the National Scripps Spelling Bee in Washington, D.C.

More than 11 million students participate in the Scripps National Spelling Bee each year.

Good Luck Spellers!

BILL GORDON ASSOCIATES

Denied Benefits? Unable To Work? We Can Help!

Fighting For Your **SOCIAL SECURITY BENEFITS** For Over 35 Years!

1

Do You Qualify For Disability Benefits? Call For A FREE Evaluation

2

Assisting With: - Initial Applications - Denied Claims - Hearings

3

We Simplify The Process & Strive For Quick Claim Approval.

You Could Be Eligible To Receive:

- Steady Monthly Income Depending On Your Paid In Amount
- A Lump Sum Payment Of Benefits Owed From Back-pay
- Health Insurance (Medicare, Medicaid Or Both)
- Annual Cost Of Living Increases

Call Now For A FREE Evaluation

BILL GORDON ASSOCIATES (844) 509-9547

Bill Gordon & Associates, a nationwide practice, represents clients before the Social Security Administration. Member of the TIA & CREF Bar Associations. Mail: 11200 NW 15th Street, D.C. Office: 11200 NW 15th Street, D.C. Services may be provided by associated attorneys located in other states. *The process for determining each applicant's disability benefits varies greatly, and can take upwards of two years.

Take Pride in our Community Keep it Clean

COMMUNITY NEWS

Hoffman MS students learn about dangers of drugs, alcohol at MEGA Brain/Lung exhibit

More than 500 Hoffman Middle School students received an up close and personal view of the dangerous affects alcohol and drugs can have on the brain and lungs when they took part in the MEGA Brain and MEGA Lung exhibit on Tuesday, Jan. 15.

The program was presented by Medical Inflatable Exhibits and launched its first MEGA Substance Abuse Program at Hoffman Middle School.

Hoffman students were able to walk through the MEGA Brain, which measures 18-feet long, 14-feet wide and 12-feet high. Students were provided with a highly interactive educational experience about the central nervous system's most critical organ. Hoffman students were able to enter the exhibits through the frontal lobe and exited through the cerebellum. Throughout the program, students learned about the various brain structures and normal brain function, observed examples of chemical dependency, specifically marijuana and alcohol on the brain.

The MEGA Lungs measures approximately 15-feet long by 10-feet high by 12-feet high. Hoffman students were also able to enter the giant exhibit between the left and right lobes under the trachea. During the program, they learned about how important the lungs are, and also learned about asthma, bronchitis, lung disease and the effects of vaping.

Hoffman student Naima Morgan was glad she took part in the program.

"It's really cool," she said. "It was neat getting



Hoffman Middle School student Naima Morgan reads information on how a stroke affects the brain during Medical Inflatable Exhibits' MEGA Brain/Lung program at Hoffman Middle School on Tuesday, Jan. 15.



Pierre Benetiz, director of education for Medical Inflatable Exhibits, discusses the effects certain diseases can have on the lungs during the MEGA Brain/Lung program presented to Hoffman Middle School students on Tuesday, Jan. 15.

to experience the functions of the brain and lungs and how bad drugs and alcohol are. I learned a lot today."

Medical Inflatable Exhibits provides large-scale, interactive, educational models of the human anatomy to help teacher young people about the risks, symptoms, nature and causes of various diseases.

The company works with a team of board-certified medical professionals to ensure the accuracy of the exhibits and the information conveyed to students. For more information about Medical Inflatable Exhibits, MEGA Brain and MEGA Lung, go to www.medicalinflatables.com.

Commissioner Ellis' Statement on County Judges Implementing Bail Reform with Local Rule Change

HOUSTON, TX – January 17, 2019 – "For too long in Harris County, money has determined whether a person languishes behind bars, separated from their family and denied due process because they cannot afford bail for nonviolent misdemeanors, while others — even those charged with violent crimes — are able to walk free if they can put up the cash.

The new rule changes enacted by the County Criminal Court judges — most of whom have been in office for a little over two weeks — demonstrate a clear commitment to upholding the Constitution and finally settling the bail



Commissioner Ellis

lawsuit in Harris County. This is an overdue first step toward leveling a two-

tiered justice system, where access to justice, liberty and due process has been based on how much money a person has in their pocket instead of their guaranteed constitutional rights.

Today is a victory for equal justice and fair treatment. Harris County will no longer be the largest county in the nation to violate the Constitution with its misdemeanor bail procedures. Instead, Harris County now has an opportunity to take the lead in implementing a holistic pretrial system for misdemeanor cases that upholds the Constitution, safeguards due process and protects our communities."

Harris County Public Health WIC centers granting benefits to federal workers

Federal employees impacted by government shutdown who are pregnant or have an infant and/or children up to age five can receive free food assistance through WIC

HOUSTON — Harris County Public Health Women, Infants and Children (WIC) Centers are granting benefit cards for free food assistance to federal employees impacted by the government shutdown. WIC — a federally funded program — provides low-income pregnant women and families with infants and/or children up to age five with healthy food, breastfeeding support, health screenings and more, at no cost. (Men of

infants or children up to age five are included.) Federal workers impacted by the shutdown can receive up to three months of WIC benefits.

WIC benefit cards look and work just like a debit card. They can be used at most grocery stores to purchase healthy foods such as milk, cheese, eggs, cereal, fruits, vegetables and more.

"We've begun to see employees from the TSA and U.S. Coastguard come in and apply for benefits," said Jolene Norbert-Harrell, HCPH WIC director. "We're more than happy to help them during their time of need. And the joy is, we can get them approved and sent home with a benefit card the same day."

"It's definitely a good resource. My kids are enjoying the fruits and vegetables," said a federal worker affected by the shutdown who chose to remain anonymous. The TSA employee, and mother of two, had never received WIC benefits before the shutdown. She stopped by the Humble HCPH WIC Center for assistance, on last week, and received her benefit card the same day.

HCPH operates 11 WIC centers across Harris County and have continued to operate under normal circumstances, in light of the government shutdown. Federal workers affected by the shutdown can call HCPH WIC offices at (713) 407-5800, to make an appointment.

Patriots Vs Rams,

CONTINUED FROM PAGE 1

been, and NO had to settle for a field goal to take a 23-20 lead.

The Rams marched down the field and tied the game with a late field goal and won the game in overtime on Greg Zuerlein's 57-yard field goal.

The missed call was costly to the Saints, but give the Rams credit for battling after they fell behind 13-0 and scratched their way back into the game.

Super Bowl LIII should be a good one as both teams have loads of offensive talent and defenses that make plays when they need to. Weather won't be a factor since this game will be played indoors, which could result in an offensive shootout.

Many thought the Patriots' dynasty was over after a so-so regular season, but they've come alive in the post season routing the Los Angeles Chargers in the Division Round and then upsetting top seed Kansas City 37-31 in the AFC Championship game in frigid conditions.

Brady has thrown for 691 yards in his first two playoff games and two touchdowns, but the offensive star has been rookie running back Sony Michel, who has rushed for 242 yards and five touchdowns in the first two playoff games of his career.

Wide receiver Julian Edelman has been steady in the post season grabbing 16 passes for 247 yards, while tight end Rob Gronkowski looked like his old self in the AFC title game grabbing six passes for 79 yards. He made a key grab in overtime that put the Pats in position for Rex Burkhead's game-winning touchdown. Brady will need Gronk to have another big day against a LA defense that is tough up front, but has issues in the secondary.

The Rams offense has been steady in the post

season putting up 30 points in the Division round win over the Cowboys and 26 points in the NFC title game. Running back Todd Gurley rushed for 115 yards against the Cowboys, but was used sparingly in the NFC title game rushing for just 10 yards, but he did score a touchdown. Gurley missed the last two games of the season with a minor knee injury and some wondered if the injury was the reason McVay had him on the bench for much of the New Orleans game. With an extra week to rest for the Super Bowl, expect Gurley (1,251 yards rushing in regular season with 21 total touchdowns) to be at full force on Sunday in Atlanta.

With Gurley limited, the Rams called on C.J. Anderson, who they signed late in the season, and he has answered the call in the playoffs. Anderson, who won a Super Bowl with the Broncos in 2016, has rushed for 167 yards and two touchdowns and is proving to be a good insurance policy in case Gurley won't be 100 percent come Sunday.

In addition to a solid rushing attack, the Rams have a talented young quarterback in Jared Goff and two dependable receivers in wide outs Brandin Cooks (11 receptions, 172 yards in the playoffs) and Robert Woods (12 receptions, 102 yards in the playoffs). Both could have big days on the fast turf in Atlanta. I expect Goff to take some chances down field early to loosen up the NE defense and open up the running game for Gurley and Anderson.

Brady doesn't have a burner at wide receiver, but he will use running back James White (87 receptions, 751 yards, 7 TDs in regular season) out of the backfield in the passing game. White should have success against the

Rams linebackers, which should open up things for Edelman and Gronk across the middle.

Brady will need another big day from Michel in the running game, but the rookie from Georgia might find things a bit more difficult this week than he has in his first two post-season games. The Rams have a stout defensive front led by reigning Defensive Player of the Year Aaron Donald (20.5 sacks in regular season) and Ndamukong Suh. In their wins over the Cowboys and Saints, the LA run defense has been excellent, limiting Dallas' Ezekiel Elliot (the league's rushing champ) to 47 yards and NO's Mark Ingram and Alvin Kamara to 46 rushing yards in the NFC title game.

Look for Belichick to test the Rams front early. If the Patriots have trouble running the ball, look for Brady to turn to White to make plays in the passing game. Belichick is too good of a coach to abandon the running game. If they are successful making plays in the passing game, look for Michel to be a factor late in the game.

This is Brady and Belichick's ninth Super Bowl, and a majority of their roster has a lot of experience playing in the ultimate game (this is NE's third straight appearance in the Super Bowl), while the Rams are novices to the big stage. That could play a factor, but McVay is a cool customer who will have his team ready to play come Sunday.

I expect the Rams to give the Patriots all they can handle and this could turn into an offensive shootout. I think this game comes down to the team that has the most experience in big games and that edge goes to the Patriots.

After losing to the Eagle last year, you had better believe Belichick will use

that as a motivating tool and with two weeks to prepare for one opponent, there's not a better football coach on the earth than Belichick.

When the dust settles, look for Brady, Belichick and the rest of the Patriots to hoist their sixth Lombardi Trophy and put to rest that the New England dynasty is over. My pick, New England 36, Los Angeles 33

Visit us on Facebook
www.facebook.com/NENewsroom

DENTAL Insurance

Physicians Mutual Insurance Company

A less expensive way to help get the dental care you deserve

- If you're over 50, you can get coverage for about \$1 a day*
- Keep your own dentist! You can go to any dentist you want
- No wait for preventive care and no deductibles - you could get a checkup tomorrow
- Coverage for over 350 procedures - including cleanings, exams, fillings, crowns...even dentures
- NO annual or lifetime cap on the cash benefits you can receive

FREE Information Kit
1-877-933-6031
www.dental50plus.com/nenews

*Individual plan. Product not available in MN, MT, NH, NM, RI, VT, WA. Acceptance guaranteed for one insurance policy/certificate of this type. Contact us for complete details about this insurance solicitation. This specific offer is not available in CO, NY, call 1-800-969-4781 or respond for similar offer. Certificate C250A (ID: C250E; PA: C250Q); Insurance Policy P150 (GA: P150GA; NY: P150NY; OK: P150OK; TN: P150TN)

H.U.D. Efficiency/One Bedroom Housing for the Elderly and Disabled

- UTILITIES & APPLIANCES FURNISHED
- ELIGIBILITY:
- Age 62 or older
- Physically Disabled
- Very Low Income

To schedule an appointment
CALL
713-692-8541

APPLY TO:
W. Leo Daniels Tower
8826 Harrell
Off Jensen between
Berry Road & Aldine
Westfield

Keep East Aldine Clean & Green!

OPINION PAGE

TEXAS SENATE NEWS
By Richard Lee

Finance Committee discusses Harvey recovery, Federal Shutdown

(Austin) Review of the supplemental budget turned to discussions about Hurricane Harvey recovery and how the federal shutdown is affecting state agencies at the Senate Finance Committee hearing on Wednesday. For the latter issue the answer is: not much, according to Legislative Budget Board Assistant Director John McGeady. He says that most agencies that depend on some level of federal funding still have plenty in reserve, though that becomes less certain should the shutdown persist through the end of February. Some agencies have staff that are paid with federal funds, and McGeady said that agencies have been able to cover those wages with state funds. He expects that they will be able to recoup those costs once federal funds start flowing again.

As for Hurricane Harvey recovery, Finance committee members talked not only about how to pay for recovery but also how to prepare for future events. Harvey dumped up to 60 inches of rain, the most ever recorded in the U.S. from a single storm, on the Texas Gulf Coast in August and September of 2017. Damage estimates for the storm top \$125 billion, making it the second most costly storm in US history, after 2005's Hurricane Katrina. The state has or will pay out millions for recovery efforts in the current biennium, and those costs have to be balanced on state ledgers.

That's where the supplemental budget comes in, and it includes \$1.2 billion in state funds, some drawn from the Rainy Day Fund, to pay for recovery efforts in the current fiscal period. McGeady laid out for the committee how those funds are earmarked in the first draft of the supplemental budget. The lion's share, \$900 million, is for public schools. Part of the first \$300 million goes towards holding districts harmless for loss of student population due to the storm. Since districts get education funding based on daily student population, losing students displaced by the storm hit local school district budgets hard. The rest is for compensatory education costs, that is, students who get more funding from the state due to some hardship. The storm increased the number of students eligible for this status, and the state must cover that cost.

The remaining \$600 million would go to cover the loss in property value caused by the storm. Since Texas funds education based on property taxes, if property values go down due to storm damage, that eats away at local school budgets. The final amount of funding to cover this loss in value and where it goes will be up to lawmakers to decide. The discussion then turned to additional issues, not only to recovery but to prevention. Lubbock Senator Charles Perry, who chairs the Senate Water and Rural Affairs Committee, studied the issue of a statewide flood plan during the interim. He cautioned his fellow members. "We can end up like a New Orleans, that still doesn't have recovery because nothing was done with oversight, coordination and collaboration" Perry said. "We need to leave here with a statewide flood plan with oversight and accountability designated for local, state and federal partners." He has filed a bill, SB 396, which would direct relevant agencies to develop a statewide plan for future flood mitigation, including provisions for regional cooperation, by 2024.

One area where the federal shutdown is impacting Texas citizens is in the flow of FEMA money towards Harvey recovery, said Brenham Senator Lois Kolkhorst. She said that in



State's top elected officials take oaths of office at inauguration

AUSTIN — Public officials and private citizens gathered at the south steps of the state Capitol on Jan. 15 for a day's worth of inaugural events, most notably the administering of oaths of office to Gov. Greg Abbott and Lt. Gov. Dan Patrick, who were reelected to four-year terms in November.

In his inaugural address, Gov. Abbott predicted the 86th regular session of the Texas Legislature, which convened on Jan. 8, would be "transformative." He said that with the help of Lt. Gov. Patrick and newly elected House Speaker Dennis Bonnen, leadership would "usher in a new era for children, teachers and taxpayers."

"We must finally rein in skyrocketing property taxes in Texas," Abbott said. "To fix this, Texas must limit the ability of taxing authorities to raise your property taxes. At the same time, Texas must end unfunded mandates on cities and counties. And taxpayers should be given the power to fire their property tax appraiser." Abbott touched on a list of other topics, such as job growth, the state's low unemployment rate, the importance of public education and public education reform, the need for teacher pay raises and better teacher retirement, enhanced school safety and progress in natural disaster recovery efforts.

Lt. Gov. delivers remarks
Patrick echoed Abbott's call to operate as a unit with Speaker Bonnen.

"The people of Texas didn't elect us to be silent on things that matter," Patrick said. "They elected us to work together and do what is right for the people of Texas. We have a moment in time, right now, to set the stage for an even greater Texas for future generations. It is within our grasp. The elections are over for now — we will have them again in two years to air out our differences — but for right now, it's time for us to work together for all of the people of Texas. I intend to do my part."

Patrick announced that

conversations this week with Nim Kidd, Chief of the Texas Division of Emergency Management, he warned her that every day of the shutdown could mean the loss of two days worth of funding. Kolkhorst raised concerns about how this could impact coastal districts. "It's kind of shut down and we're at a standstill on the housing issue that we see in my district, and then also some of the other FEMA funds that could come to our local communities for mitigation and for repair" she said. This is an issue that's out of state lawmakers' hands, as they wait for a resolution in Washington D.C.

The Senate will reconvene Monday, January 28 at 3 p.m.

STATE CAPITAL HIGHLIGHTS
By Ed Sterling

Sen. Jane Nelson, R-Flower Mound, chair of the Senate Finance Committee, has filed Senate Bill 3, which he called "the first across-the-board pay increase for Texas teachers in nearly 20 years." SB 3, he said, would give every one of Texas' 350,000 teachers a \$5,000 raise beginning in the next school year, and that would be the first step in increasing the base pay of teachers by \$10,000. Patrick added that Nelson also had filed Senate Bill 1, the state budget, legislation that includes \$3.7 billion to fund the teacher pay raise.

Panel chairs are named

Patrick, who presides over the state Senate, on Jan. 18 made public his selection of 16 committee chairs and members of each panel.

The appointments, he said, "reflect the proven leadership, commitment, solid work ethic and wide range of expertise of the 31 senators who have been elected by the people of Texas to represent them." Complete lists of panel members may be found at www.senate.texas.gov. These are chairs and vice chairs for each panel:

- Agriculture: Kel Seliger, R-Amarillo, and Jose Rodriguez, D-El Paso;
- Administration: Bryan Hughes, R-Mineola, and Pat Fallon, R-Prospers;
- Business & Commerce: Kelly Hancock, R-North Richland Hills, and Robert Nichols, R-Jacksonville;
- Criminal Justice: John Whitmire, D-Houston, and Joan Huffman, R-Houston;
- Education: Larry Taylor, R-Friendswood, and Eddie Lucio Jr., D-Brownsville;
- Finance: Jane Nelson, R-Flower Mound, and Juan "Chuy" Hinojosa, D-McAllen;
- Health & Human Services: Lois Kolkhorst, R-Brenham, and Charles

Perry, R-Lubbock;
— Higher Education: Brandon Creighton, R-Conroe, and Royce West, D-Dallas;

— Intergovernmental Relations: Eddie Lucio Jr., and Charles Schwertner, R-Georgetown;

— Natural Resources & Economic Development: Brian Birdwell, R-Granbury, and Judith Zaffirini, D-Laredo;

— Nominations: Dawn Buckingham, R-Lakeway, and Kirk Watson, D-Austin;

— Property Tax: Paul Bettencourt, R-Houston, and freshman Angela Paxton, R-McKinney;

— State Affairs: Joan Huffman, and Bryan Hughes;

— Transportation: Robert Nichols and Kelly Hancock;

— Veterans Affairs & Border Security: Donna Campbell, R-New Braunfels, and Bob Hall, R-Edgewood; and

— Water & Rural Affairs: Charles Perry, and Brandon Creighton.

Jobless rate stays low

December was the 104th consecutive month of positive employment growth, the Texas Workforce Commission reported Jan. 18.

Texas gained some 38,000 seasonally adjusted non-farm positions during the month, pegging the unemployment rate at 3.7 percent and maintaining the same historic 43-year low the state has enjoyed since October 2018.

The Midland Metropolitan Statistical Area recorded December's lowest unemployment rate among Texas MSAs with a non-seasonally adjusted rate of 2.1 percent, followed by the Amarillo MSA and Odessa MSA, which tied for the second lowest with a rate of 2.6 percent. The Austin-Round Rock MSA recorded the third lowest rate of 2.7 percent.

LETTER To The Editor

Dear Sir,
I am 76 years old. I never thought I would live to see the day that you would print an article with a Conservative point of view. Finally, after all these years of reading (actually skipping) the Liberal Propaganda in

your paper, your article by Dan Crenshaw was long overdue. Some balance in your opinion section is appreciated. We Conservatives are not extinct yet and are grateful for any bones thrown our way.
Sincerely,
Robert Szymiczek

ASK RUSTY:
Will my benefit be the same as my current SS statement says?

By AMAC Certified Social Security Advisor Russell Gloor Association of Mature American Citizens

Dear Rusty: I recently retired after more than 40 years in the construction industry. I'm 60 years young and my wife and I recently moved south to enjoy retirement in a new and milder environment. At this point, we do not plan on receiving my SS benefit until I reach my full retirement age of 66 and 8 months. In my 2018 statement, the Estimated Benefits Section, it states "You have enough credits to qualify for benefits at your current earning rate. (If you continue working until your full retirement age of 66 years and 8 months your payment will be)" Then it shows an amount for my full retirement age, age 70 & age 62. My question is, if I don't work from now to my full retirement age will that significantly reduce my SS benefit rate that is quoted on my statement? Signed: Retired early

Dear Retired: Congratulations on your retirement! The estimated benefits shown on the statement you received from Social Security are just that - estimates. But they make a critical assumption which will, indeed, make a difference in the actual amount of your benefit when you finally claim it.

Those estimates assume that you will continue working at your current income level until you reach your full retirement age (FRA). But since you retired from work at age 60 your actual benefit (assuming you continue without working) will be less than the current estimates you have from Social Security. Whether the reduction will "significantly reduce" your benefit depends on your actual earnings in the 35 years used to compute your benefit when you claim. Your benefit is determined by adjusting for inflation all your lifetime earnings as reported to the IRS (but only up to the annual payroll tax cap for each year). They then select the highest earning 35 years over your lifetime, total them and divide by 420 (number of months in 35 years) to arrive at your "average indexed monthly earnings," or AIME. This is a number used to compute your actual benefit amount.

Since the highest earning years are usually the ones later in your working career, stopping work before you reach FRA will yield a lower benefit - if the estimated benefit computation used the predicted earnings

between age 60 and your FRA to arrive at your benefit estimate. The key parameter used to determine your actual benefit amount is something called your "primary insurance amount" (PIA), which is computed from your AIME and is your benefit at your full retirement age.

If you claim before FRA, your benefits will be reduced according to the number of months before that you claim (reduced by about 6.7% for each of the first 3 years early and then 5% more for any years more than 3 years prior to your FRA). Conversely, if you wait beyond FRA to claim, your benefit will grow at 8% per year until you are 70, when it would be 26.7% more than it would be at your full retirement age.

Of course, you don't have to wait until age 70 to apply, because you'll earn delayed retirement credits (DRCs) of 2/3rds of 1% per month of delay beyond your full retirement age. But the longer you wait to claim, the more your benefit will be (up to age 70), thus possibly easing the impact of any benefits lost by not working until your FRA.

To summarize, if you don't work between now and your FRA, your benefits will be probably be less than shown in your most recent estimate. If you work and have earnings for some years after age 60, and those earnings are more than any of the 35 used to compute your estimate, the higher current earnings will be used to compute your final benefit amount. And if you delay beyond your FRA to claim benefits you may recover (thru DRCs) some of what was lost by not working between age 60 and your FRA. I realize this isn't a specific answer about how much less your benefit might be, but I hope this answers your basic question.

This article is intended for information purposes only and does not represent legal or financial guidance. It presents the opinions and interpretations of the AMAC Foundation's staff, trained and accredited by the National Social Security Association (NSSA). NSSA and the AMAC Foundation and its staff are not affiliated with or endorsed by the Social Security Administration or any other governmental entity. To submit a question, visit our website (amacfoundation.org/ programs / social-security-advisor) or email us at ssadvisor@amacfoundation.org.

NORTHEAST NEWS
5906 Star Lane, Houston, TX 77057
(713) 266-3444 • FAX (713) 977-1188
email: nenevroom@aol.com website: www.nenevroom.com
Founded in 1977 by Vic & Donna Mauldin
Gilbert Hoffman.....Editor & Publisher
Mei-Ing Hoffman.....Associate Publisher
Lewis Spearman.....Advertising Director
Willie G Glasgow.....Marketing Executive
Julietta Paita.....Assistant Editor
Luis Hernandez.....Production Mgr.
Gerardo Hernandez.....Asst. Production Mgr.
Published each Tuesday by GrafikPress Corp. Any erroneous statement which may appear will be corrected when brought to the attention of the publisher. Liability for errors is limited to the reprinting of the corrected version. Submissions are encouraged, in person, by mail, by Fax, or by email, to nenevroom@aol.com
Founding Member North Houston Chamber (now Houston Intercountry) Member Texas Press Association

Take Pride in our Community Keep it Clean
EAST ALDINE DISTRICT

ENTERTAINMENT

Posting Date January 28, 2019

Amber Waves

by Dave T. Phipps



Out on a Limb

by Gary Kopervas



R.F.D.

by Mike Marland



The Spats

by Jeff Pickering

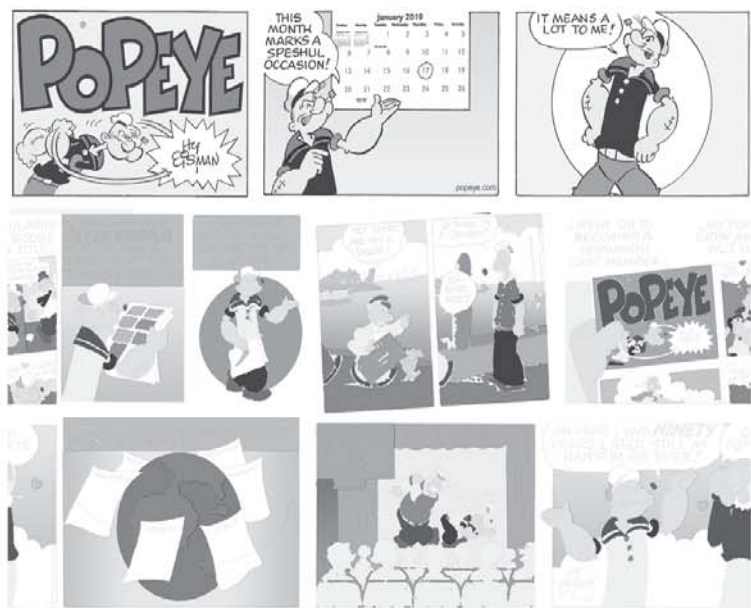

Just Like Cats & Dogs

by Dave T. Phipps



LAFF-A-DAY



SCRAMBLERS

Unscramble the letters within each rectangle to form four ordinary words. Then rearrange the boxed letters to form the mystery word, which will complete the gag!

Deepen
GEDDER

Cheer
ASPIRE

Adore
DREAMI

Secede
TAPERD

TODAY'S WORD

King Crossword

1	2	3	4	5	6	7	8	9	10	11
12							13			14
15							16			17
18							19			20
21							22			
23	24	25					26			27
30							31			32
33							34			35
36							37			38
39							40			41
42							43			44
45							46			47
48							49			50
51							52			53
54							55			

- ACROSS**
- 1 Soybean paste
 - 5 Young fellow
 - 8 In the thick of
 - 12 Pastoral poem
 - 13 Hockey surface
 - 14 Start over
 - 15 Tear
 - 16 Some inoculations
 - 18 Left the premises
 - 20 Grown-up nit
 - 21 Petrol
 - 22 Jan. and Feb.
 - 23 Building wing
 - 26 Battery brand
 - 30 Golf prop
 - 31 Whammy
 - 32 Equal (Pref.)
 - 33 Combat-zone helicopter
 - 36 Connection
 - 38 Express
 - 39 Peruke
 - 40 Accumulate
 - 43 Empty spaces
 - 47 Time away from work
 - 49 Largest of the seven
 - 50 TV trophy
 - 51 Conk out
 - 52 Trawler equipment
 - 53 Actor Roger
 - 54 Peculiar
- DOWN**
- 1 Nuclear missile acronym
 - 2 Concept
 - 3 Harmonization
 - 4 Senescence
 - 5 A cat has nine
 - 6 Mil. sch.
 - 7 Nov. follower
 - 8 Melodious
 - 9 List of options
 - 10 Mid-March
 - 11 Medicinal amount
 - 17 Satiating
 - 19 Levy
 - 22 Baer or Schmelgel of boxing
 - 23 \$ dispenser
 - 24 Born
 - 25 Homer's neighbor
 - 26 Fun 'n' games
 - 27 Compete
 - 28 "— was saying, ..."
 - 29 Anti
 - 31 Dinner for Dobbin
 - 34 English compositions
 - 35 Expansive
 - 36 Twitch
 - 37 Galapagos lizard
 - 39 Subsided
 - 40 State
 - 41 Jerry Herman heroine
 - 42 Pinnacle
 - 43 Null and —
 - 44 Secondhand
 - 45 Teeny bit
 - 46 Back talk
 - 48 Altar affirmative

Weekly SUDOKU

by Linda Thistle

1	7	9		6				
		3		7		9	1	
2			4					8
	1			8	5			
9		4					8	
		5	1					2
	3	8			2	7		
7			6				1	
	9	2		1				4

Place a number in the empty boxes in such a way that each row across, each column down and each small 9-box square contains all of the numbers from one to nine.

DIFFICULTY THIS WEEK: ♦♦♦

♦ Moderate ♦♦ Challenging
♦♦♦ HOO BOY!

© 2019 King Features Synd., Inc.

Trivia test

by Fifi Rodriguez

- MOVIES: Which 1969 movie featured the song "Raindrops Keep Fallin' on My Head"?
- LITERATURE: What is the name of Harry's owl in the "Harry Potter" book series?
- MUSIC: Which American actor performs music as his alter ego Childish Gambino?
- FOOD & DRINK: Which kids' snack, contained in a box with a string handle, was first marketed in 1902?
- GAMES: In what game is a shuttlecock used?
- SPACE: Who piloted America's first and shortest flight into space?
- ANIMAL KINGDOM: Which fish is the fastest in the world?
- GEOGRAPHY: What is Saigon's current name in Vietnam?
- ART: Which city is home to the statue "David" created by Michelangelo?
- MONEY: What was the basic currency of Greece before the euro?

HOCUS-FOCUS

BY HENRY BOLZOFF

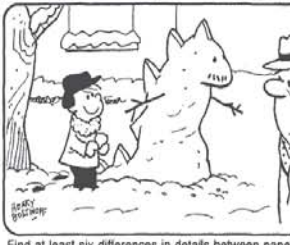

Differences: 1. Window is missing. 2. Man has moustache. 3. Boy is drinking. 4. Snow creature is shorter. 5. Man's feet is different. 6. Creature's name has more bumples.

- King Trivia Test Answers
1. "Butch Cassidy and The Sundance Kid"
 2. Hedwig
 3. Donald Glover
 4. Animal-shaped crackers then known as "Barnum's Animals"
 5. Badminton
 6. Alan Shepard, 1961, 15 minutes
 7. The black marlin
 8. Ho Chi Minh City
 9. Florence, Italy
 10. Drachma

Solution time: 21 mins.

R	E	E	S	O	O	D	D	A	E	S
E	M	V	D	L	E	M	E	T	S	
V	A	C	V	T	O	N	A	S	V	A
A	M	A	S	S	A	C	O	U	S	
S	A	V	I	W	I	G				
M	E	D	E	A	C	T	I	E	I	
O	S	I								
V	A	N	N	E	X	H	A	V	O	A
G	A	S								
V	A	C	A	T	E	O	L	O	U	S
R	E	M	V	A	C	I	N	E	S	
I	D	L	I	G	E	R	E	D	O	
M	I	S	O	L	A	M	I	D		

CryptoQuip

This is a simple substitution cipher in which each letter used stands for another. If you think that X equals O, it will equal O throughout the puzzle. Solution is accomplished by trial and error.

Clue: D equals Y

HY DLR CUPZ U FLJ GZZFUDHMK
YLV U IRQHA QSUSLHM. HS IHKCS
JZ QUHG SCUS DLR UWZ WUGHL-
UASHPZ.

© 2019 King Features Synd., Inc.

King Crossword

Answers

6	9	2	3	7	1	8	5	4
7	4	8	5	6	2	9	1	3
5	3	1	8	9	4	2	7	6
4	8	5	7	1	9	3	6	2
9	2	6	4	3	5	1	8	7
3	1	7	6	2	8	5	4	9
2	5	9	1	4	6	7	3	8
8	6	3	2	5	7	4	9	1
1	7	4	9	8	3	6	2	5

Weekly SUDOKU

If you have a job developing answers for a music station, it might be said that you are radio-active.

RETIRE

Today's Word

SCRAMBLERS

1. Dredge; 2. Parole; 3. Admire; 4. Pared.

LIFESTYLE

RECENT DEATHS

Michael Lee Hammond
 Jose "Joe" Guadalupe Arellano
 Kyu R. Trout
 Virginia Morado
 Charlotte Lynn Hardin
 Jeffrey Michael Kirsch

Alene Oneta Pogue
 Maria Rosa Carillo
 Guy Furgiuele
 Amanda Jane Chambers
 Lillie Maybell Jaetzold
 William Lewis Fernandez



Bonding Against Adversity
 HELPING OTHERS HELP THEMSELVES

Community Outreach Programs
 "Helping Others Help Themselves"

Immigration Education and Integration Program
 Citizenship Classes - Parenting Education

Mariana Sanchez, Director
 Text to: 832-906.4214
 Phone: 281-799.9076
 marianas@bondingagainstadversity.org

Castlewood CIVIC CLUB,

CONTINUED FROM PAGE 1



Commissioner Adrian Garcia listens to Castlewood residents on community concerns; he explained that flooding, and street lighting are on the Pct. 2 agenda.

appropriate lighting in the general area. Particular focus is being dedicated to the water drainage coming from Maya Park through Connorsvale and possible repurposing of the area off Aldine Westfield on Gault.

A follow up meeting will be forthcoming in a month at Bethel Community Church, Comm. Garcia added. All Castlewood residents are invited to attend and become informed of the improvements.



Commissioner Adrian Garcia talks to Castlewood residents

CLASSIFIED THE FRUGAL FROG CLASSIFIED

CALL 713-266-3444 TO REACH 60,000 READERS

A/C & APPLIANCE REPAIR

MARIO'S APPLIANCE REPAIR
 All Major Brands. In-Home Service, 20 yrs. experience. Reparo electrodomesticos, todo tipo de modelos. Call Mario, 713-291-8286.

ELECTRICIAN

ELECTRICIAN
 All types of new wiring and repairs
D&E ELECTRIC
 Since 1975
 Low Rates
 281-448-8615
 4-tfn

HELP WANTED

SALES REPRESENTATIVE
 Part Time Position available for Newspaper ad sales person for the Aldine and North Channel areas. Set your own hours. Commission basis means you can earn more. Bilingual helpful. Car required. Send resume to nnewsroom@aol.com.

HOME IMPROVEMENT

SEMI-RETIRED
 Handyman will do carpentry, painting, roof repairs, mobile homes, pressure washing. Lifetime Houstonian. 713-754-0923. Don. 16-tfn

Keep East Aldine Clean & Green!



Classified Ads, Call 713-266-3444

WE BUY OIL, GAS, & MINERAL RIGHTS

Both non-producing and producing including Non-Participating Royalty Interest (NPRI)
 Provide us your desired price for an offer evaluation.

CALL TODAY: 806.620.1422

LOBO MINERALS, LLC
 PO Box 1800 • Lubbock, TX 79408-1800
 LoboMineralsLLC@gmail.com

LEGAL ADVERTISING

You now have the option of placing your Legal Ads in a local newspaper that meets your requirements, reaches more readers in your area, and costs much less. Rates are \$10.00 per column inch, plus \$10 for an affidavit, or 50¢ per word plus affidavit. We can give you an exact quote if required. Please call or email for assistance. Thank you for supporting our community and keeping our dollars local.

NORTHEAST BELTWAY 8 News
 A GrafikPress Newspaper
 713-266-3444 email: nnewsroom@aol.com

TEXAS STATEWIDE CLASSIFIED ADVERTISING NETWORK

TexSCAN

TexSCAN Week of January 27, 2019

ACREAGE
 23.35 acres. Windmill, borders large ranch near Robert Lee and Lake E.V. Spence. Mesquite and cedar cover. Whitetail, hogs, turkey, quail, dove. \$3,370 down, \$558/mo., (9.9%, 20 years.) 800-876-9720, www.ranchenterprisesltd.com.

SAWMILLS

Sawmills from only \$4,397.00 – Make & Save Money with your own bandmill – Cut lumber any dimension. In stock, ready to ship! Free info/DVD: www.NorwoodSawmills.com. 800-567-0404, Ext.300N.

CHARITY

Donate a boat or car today to Boat Angel. 2-Night Free Vacation. Sponsored by Boat Angel Outreach Centers to stop crimes against children. 800-700-BOAT, www.boatangel.com.

LEGAL ASSISTANCE

Roundup®, a common weed and grass killer, may be linked to the development of Non-Hodgkin's Lymphoma in farm workers and employees in garden centers, nurseries, and landscapers. Call 800-460-0606 for professional insight or visit www.RespectForYou.com/NHL.

EVENTS

San Antonio Stock Show & Rodeo, Feb. 7-24. For entertainment lineup and tickets, go to sarodeo.com. 210-225-5851.

TRUCK DRIVERS

Be Your Own Boss! Get Paid to See the Country! Quality Drive-Away is looking for CDL Drivers to deliver new trucks. www.qualitydriveaway.com, 574-642-2023.

OIL AND GAS RIGHTS

We buy oil, gas & mineral rights. Both non-producing and producing including non-Participating Royalty Interest (NPRI). Provide us your desired price for an offer evaluation. 806-620-1422, LoboMineralsLLC@gmail.com. Lobo Minerals, LLC, PO Box 1800, Lubbock, TX 79408-1800.

WANTED

FREON R12 WANTED: Certified buyer will PAY CASH for R12 cylinders or cases of cans. 312-291-9169; www.refrigerantfinders.com.

ADVANCED HEARING AID TECHNOLOGY

"I was amazed! Sounds I hadn't heard in years came back to me!" — Don W., Sherman, TX

For Less Than \$200 MDHearingAid

How can a hearing aid that costs less than \$200 be every bit as good as one that sells for \$2,250 or more?

The answer: Although tremendous strides have been made in Advanced Hearing Aid Technology, those cost reductions have not been passed on to you. Until now...

MDHearingAid® uses the same kind of Advanced Hearing Aid Technology incorporated into hearing aids that cost thousands more at a small fraction of the price.

Over 300,000 satisfied MDHearingAid customers agree: High-quality, FDA-registered hearing aids don't have to cost a fortune. The fact is, you don't need to spend thousands for a hearing aid. MDHearingAid is a medical-grade hearing aid offering sophistication and high performance, and works right out of the box with no time-consuming "adjustment" appointments. You can contact a licensed hearing specialist conveniently online or by phone — even after your purchase at no cost. No other company provides such extensive support. Now that you know...why pay more?

Can a Hearing Aid Delay or Prevent Alzheimer's and Dementia?

A study by the National Institute on Aging suggests older individuals with hearing loss are significantly more likely to develop Alzheimer's and dementia over time than those who retain their hearing. They suggest that an intervention — such as a hearing aid — could delay or prevent this by improving hearing!

Take Advantage of our 45-Day Risk-Free Trial!

Hearing is believing and we invite you to try this nearly invisible hearing aid with no annoying whistling or background noise for yourself. If you are not completely satisfied with your MDHearingAid, return it within 45 days for a FULL REFUND.

For the Lowest Price Call 1-855-502-4986

Use Code HQ99 and get FREE Batteries for 1 Year Plus FREE Shipping

Texas Press Statewide Classified Network

283 Participating Texas Newspapers • Regional Ads

Start At \$250 • Email ads@texaspress.com

NOTICE: While most advertisers are reputable, we cannot guarantee products or services advertised. We urge readers to use caution and when in doubt, contact the Texas Attorney General at 800-621-0508 or the Federal Trade Commission at 877-FTC-HELP. The FTC web site is www.ftc.gov/bizop.

CHURCH PAGE

Activities at Jones Park

Tai Chi: Wednesday January 30 at 9 a.m. Interested in trying a new healthy outdoor activity? Tai Chi is a centuries-old activity shown to reduce osteoarthritis pain and improve quality of life, reasoning ability, balance, and stability. John Spencer, volunteer Tai Chi instructor, leads this class based on the 24-step Yang form of Tai Chi. The one-hour class includes low-impact stretching, breathing, and range of motion exercises held in the outdoor classroom near the Nature Center.

Homestead Open House: Wednesdays and Saturdays from 1 p.m. to 4 p.m. Appreciate modern conveniences by taking a step back in time. Enjoy a look around the park's historically accurate 1830's

Redbud Hill Homestead and Akokisa-Ishak Village. Learn about two very different, yet successful ways of life. Self-guided interpretive brochures are available in the Nature Center, so visitors can move at their own pace.

Nature Photo Contest: It's time for the park's annual photo contest! Get your cameras ready and join in the fun. This contest

is open to all amateur photographers except for Harris County Precinct 4 employees. Call for rules and information or visit www.hep4.net/Community/Parks/Jones/Contest.

Jesse H. Jones Park & Nature Center is located at 20634 Kenswick Drive in Humble. For more information about the park please call 281-446-8588.

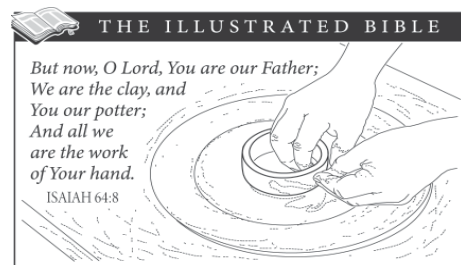

BIBLE TRIVIA

by Wilson Casey—

1. Is the book of 2 Samuel in the Old or New Testament or neither?
2. From 1 Corinthians 16, on which day did Paul tell believers to put aside money for their offerings? First, Third, Fifth, Sabbath
3. Which book (KJV) begins, "Blessed is the man that walketh not in the counsel of the ungodly"? Judges, Ruth, Ezra, Psalms
4. What was Matthew's occupation before becoming a disciple? Tentmaker, Tax collector, Fisherman, Shepherd
5. In Esther 2, who foiled a plot to assassinate King Ahasuerus? Neco, Amaziah, Mordecai, Joshua
6. What did Ruth and Boaz name their son? Obed, Hushai, Abner, Jehu

ANSWERS: 1) Old; 2) First; 3) Psalms; 4) Tax collector; 5) Mordecai; 6) Obed

Church Page Sponsors

If you would like to be a Church Page Sponsor, please call 281-449-9945

ALDINE FAMILY HOPE CENTER
4700 Aldine Mail Rt., Houston, 77039
(Next to Hambrick Middle School)

After School Program	Summer Program	GED & ESL
Resource Center	Resale Shop	Counseling
Senior Program	Food Pantry	Computer Classes
Family Activities	Teen Job Training	Sports

281-449-4828 www.aldineyouth.org

First Baptist Church North Houston

Where Jesus Has the Priority And Everyone is Welcome

Winter Bible Conference

February 1-3

Friday 2/1 - 7PM -9:30PM

Saturday 2/2 - 9AM-2:30PM

Sunday 2/3 - 9:45AM-12:15PM

Complimentary Continental Breakfast and Lunch on Saturday.

4422 Lauder Road, Houston, TX. 77039 281-449-7201

THE FRUGAL FROG

CALL 713-266-3444 TO REACH 60,000 READERS

SERVICES	RENT/LEASE	RENT/LEASE	RENT/LEASE
<p>J.D. FENCE We install & repair fences. All types of chain link, wood ornamental and iron. Free estimate. Small jobs welcome. Call Jose 281-221-0637.</p>	<p>EFFICIENCY in Aldine area off of JFK and Lauder Rd. \$600/mo. + deposit. Furnished. All bills paid. Call Kathy 281-948-7985</p>	<p>HALL FOR RENT \$550 For 4 Hours Includes Dance Floor, Bandstand and Bar - Seats 250 VFW POST 9187 6101 E. Mount Houston For Information Call: 281-987-1392</p>	
SERVICES	PLUMBING	SERVICES	SERVICES
<p>PART SERVICES R.F. Hull Water Well - Pump Service. 281-442-5630.</p>	<p>ANDY ELIZARDO PLUMBING Master Plumber All types of Plumbing Repairs and Drain Cleaning. Discount for Seniors. CALL for FREE ESTIMATE 281-441-3390</p>	<p>TEJAS TRANSMISSIONS Houston's Only Standard & Automatic Specialists FREE Computer Diagnostics Quality Work! Since 1997 Full 12 Mo. Or 12,000 Mile Warranty "We Will Honor Other Shops Coupons" Se Habla Español 225 Aldine Mail Route, 77037 281-931-9300</p>	

YOU ARE ONE CALL AWAY FROM A NEW HEAD OF HAIR

Discover the next generation hair restoration.

To see how great your hair can look, get our FREE book 'The Complete Guide to Hair Restoration' New non-surgical and surgical hair restoration solutions available.

BOSLEY
Professional Services Provided by the Affiliated Physicians of the Bosley Medical Group

ACT NOW AND GET A \$250 GIFT CARD*

CALL 877-253-9561
or www.hairexpert.us/nenews

Business Directory

SHOP LOCALLY -- Save Time & Money

<p>A/C & HEAT REPAIR</p> <p>Amigos Residential Service LLC License # TACL44848E Air conditioning & Heating • New system installation & repair • All brands 832-455-0788 Frank 832-867-6550 Raul www.amigosresidentialservice.com</p>	<p>ROOFING SERVICES</p> <p>Financing Available Free Estimates</p> <p>MR. ROOFER Siding & Contracting LLC 281-452-0000 CERTIFIED CONTRACTOR New Roofs • Repairs • Painting • Hardi Plank Siding P.O. Box 914, Channelview, TX 77530 Mroofer@mail.com =Major credit card accepted=</p>
<p>HOME IMPROVEMENT</p> <p>Garage Doors & Electric Openers Repair or Replace. We also repair broken springs. Call Ricardo 832-647-6378</p>	<p>TREE SERVICES</p> <p>FREE Estimates • Over 20 years Exp.</p> <p>Mr. Lopez TREE SERVICE *AFFORDABLE PRICES* Removal, Cutting, Pruning, Trimming, Topping, Stump Grinding J. Lopez 281-827-5978 Call or Text</p>
<p>UPHOLSTERY & AWNING</p> <p>Tapiceria PRAT Upholstery & Awning COMMERCIAL & RESIDENTIAL RAPHAEL PRAT 2021 Aldine Mail Rt. Suite 902 281-590-7562 Houston, TX 77039</p>	<p>AUTO, HOME INSURANCE</p> <p>FARMERS INSURANCE Carlos Diaz Agente DIAZ INSURANCE AGENCY Auto, Home, Commercial, Life Call For A Quote Today 832-698-2916 Fax: 281-971-1702 cdiaz@farmersagent.com DIAZ INSURANCE AGENCY</p>
<p>COMMERCIAL PRINTING</p> <p>Commercial Printing We specialize in 4 Color Brochures, Magazines, Sale Flyers, We print Newspapers, too. Call for a Quote GRAFIKSHOP 713-977-2555</p>	<p>TREE SERVICE</p> <p>FREE ESTIMATES PROMPT SERVICE LICENSED & INSURED Specializing in sick trees TREES OF TEXAS Professional Tree Service PRUNING, REMOVALS, SPRAYING, STUMP GRINDING, DIAGNOSIS OF SICK TREES, FEEDING "LEAF IT TO US" CARL GUTKOWSKI (713) 461-4275 OWNER 24 HRS - (713) 530-1526</p>

CALL 713-266-3444 to place your Business Card in our Directory. Thousands of Readers in this area will see your message.

THIS WEEK'S

FEATURED BUSINESS

TREE SERVICES

FREE Estimates • Over 20 years Exp.

Mr. Lopez TREE SERVICE
AFFORDABLE PRICES

Removal, Cutting, Pruning, Trimming, Topping, Stump Grinding

J. Lopez 281-827-5978 Call or Text

Richard Cantu holds "Thank You" Reception



RICHARD CANTU, the Assistant Director for the East Aldine District, was elected in November as a member of the Harris County School Board. To thank all his supporters, he held a Victory reception at Mannie's Seafood Restaurant last week. Pictured above are Patti Acosta, Connie Esparza, Steve Mead, State Senator Carol Alvarado, Richard Cantu, Art Murillo, and Joyce Wiley, just a few of the attendees at the event.



FAMILY AND FRIENDS joined Richard Cantu, center, and wife Thelma, at right, to celebrate the victory and help Cantu thank all his supporters in the recent election.

Bond Rating,

CONTINUED FROM PAGE 1

district. A fully funded debt service reserve fund equal to the lesser of the maximum annual debt service (MADS) requirement or the maximum amount in a reasonably required reserve fund that management can invest without restriction as to yield further secure the bonds. We rate the bonds under our Priority Lien criteria, which factors in both the strength and stability of the pledged revenues, as well as the general credit quality of the municipality where taxes are distributed and/or collected (the obligor's creditworthiness or OC).

While the district has maintained a very strong reserve position compared to the overall budget, we believe the overall operational revenue stream is concentrated with sales tax revenue representing the majority of the operating revenues.

While the operating revenues lack diversification, we believe the district's budgetary practices are conservative enough to allow for flexibility to adjust to unfavorable budget performance and maintain very strong reserves. Additional strengths include the district's good wealth and income levels and relatively low debt profile. Offsetting

factors are the district area's adequate market value per capita levels and concentration in the operating revenue base that can be susceptible to down cycles. The priority-lien rating on these bonds is limited by our view of the obligor's creditworthiness and is constrained from being raised unless there is improvement in the OC.

Economic fundamentals: Strong-to-very strong The roughly 20.3-square-mile district is about 15 miles north of downtown Houston in an unincorporated part of Harris County. The district is home to approximately 55,000 residents in an older area of the county. Houston median household and per capita effective district buying incomes are, in our view, good at 104% and 103%, respectively, of national averages. Retail sales tax generators in the district include a Home Depot home improvement center, M.S. International Inc. (a distributor of flooring, wall, and countertop surfaces), and other retailers and manufacturing companies. The district also has significant business-to-business sales tax activity that officials estimate accounts for a significant amount of collections. Due to the size of the district

and the relative size of its leading sales taxpayers, the district's sales tax base, while still concentrated, has moderated with the 10 leading sales tax remitters making up approximately 32% of 2018 collections compared to 40% of total sales tax collections in 2016. Management does not currently have any concerns with its leading taxpayers due to the support and strength of consumer retail and manufacturing operations in the district. We expect future commercial and retail growth will continue to provide for stable growth in sales tax revenue over the next two years.

Management is currently projecting fiscal 2018 pledged revenue will provide approximately \$10 million, or 4.14x MADS. The district conservatively budgets for revenues at \$8.5 million, but we expect economic activity will continue to increase and provide very strong DSC.

The Texas Legislature created the district in June 2001 to enhance the physical, social, and economic well-being of the Aldine community. It is a governmental entity administered by an appointed nine-member, all volunteer board of directors.

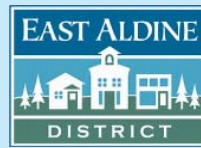

East Aldine District NEWS REPORT

Design of new East Aldine Office Building gets board approval

East Aldine Management District will build a new office building in the Town Center for use by itself and the community. Planning of the building has been underway for about six months by a facilities committee of the board, and the design consultants. A recent change in the design has increased the height of the building to three stories. Materials have been selected to be compatible with the design standards that all buildings at Town Center are adhering to. The board authorized the consultants to proceed with construction documents, with a schedule of completion of construction in 2020. The building and adjacent park are budgeted at \$15 million dollars. Design consultants are PGAL architects, and Clark-Condon landscape design.



The front of the building has a covered entry. Materials are stone, wood, and metal siding similar to buildings at the Baker Ripley complex.



The building includes an outdoor deck on the second level, with views out to the park and amphitheater.

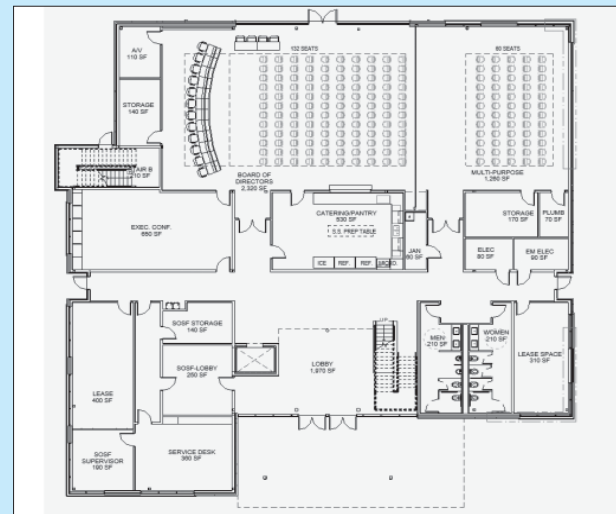

The First Floor Plan shows a 2 story entrance lobby, Sheriff's storefront at the left, and public meeting rooms at the center and rear for the District functions. The 2nd and 3rd floors above include offices for the District, the Contract Deputies, and lease space expected to be occupied by services to the public.



The Site Plan shows the New East Aldine building with the park and amphitheater adjacent to the north. Baker Ripley is further to the north, Lone Star College to the left, the Harris County 911 Call Center to the lower right, and a new JoeV's supermarket to the upper right. Features of the park include the grass amphitheater and performance stage, a child's playground, a splash pad, and meandering brooks and walkways.

Your Home Owners Insurance Is Not Complete

A Home Warranty Is the Perfect Complement to Your Home Owners Insurance.



Home appliances and systems break down, that's when you need a home warranty from American Residential Warranty to help with the repair or replacement cost.

LIMITED TIME OFFER: \$20 OFF



All our plans can be tailored to fit your needs. ARW's Most Popular Plans:

Platinum Premier
Our best, most popular and comprehensive warranty plan that covers home appliances, air conditioning, plumbing and more.
\$54.99 per month

The Ultimate Electronics Protection
Covers your new and used electronics, from laptops to TVs and Tablets plus more. No proof of purchase required... Ever!
\$24.99 per month

Kitchen Plus
Covers all your major kitchen appliances, electrical and water heater.
\$29.99 per month

3-in-1 Bundle
Stay worry-free knowing your home is protected all-around, our bundle plan includes 3 of our best coverages in one bundle plan: Platinum Premier, Deluxe Advantage (extends coverages) and The Ultimate Electronics Protection.
Promotional Price: \$89.99 per month

CALL NOW: 866-653-6132
*One-Time Discount

